



# BRAND CHT® PATTINI TENDICATENA TIPO CHT - GA CHT - GE CHT - GO

PATTINI TENDICATENA CHT - GA CHT - GE CHT - GO

- Pattini tendicatena in polietilene UHMW ad alto peso molecolare (1.000.000)
- Forniti con kit boccola che permette il movimento folle del pattino solo GE
- Disponibile su richiesta in altri colori

**GE**

Semplice B1

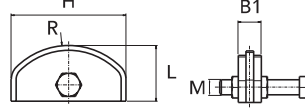

**GO**

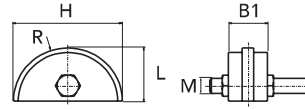

**GA**

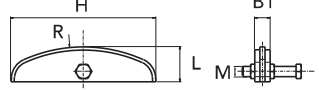

Doppio B2

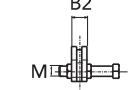
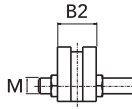
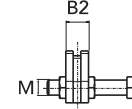

Triplo B3

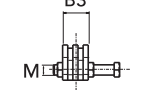
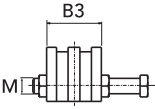
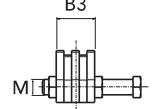

ARTICOLO	CODICE SEMPLICI	CODICE DOPPIE	CODICE TRIPLE	PASSO CATENA	B1	B2	B3	L	M	H	R	PESO Kg.
<b>GE</b> GE - 3/8"	94090901	94090902	-	3/8 x 7/32"	20	20	-	34	M8	68 <sup>-0/+2</sup>	42	0,10
GE - 3/8"	-	-	94090903	3/8 x 7/32"	-	-	25	34	M10	68 <sup>-0/+2</sup>	42	0,10
GE - 1/2"	94091201	94091202	94091203	1/2" x 5/16"	20	20	35	34	M10	68 <sup>-0/+2</sup>	42	0,11
GE - 5/8"	94091501	94091502	-	5/8" x 3/8"	20	25	-	44	M10	88 <sup>-0/+2</sup>	54	0,17
GE - 5/8"	-	-	94091503	5/8" x 3/8"	-	-	40	44	M12	88 <sup>-0/+2</sup>	54	0,17
GE - 3/4"	94093401	94093402	-	3/4" x 7/16"	20	30	-	44	M10	88 <sup>-0/+2</sup>	54	0,19
GE - 3/4"	94091901	94091902	94091903	3/4" x 7/16"	20	30	49	44	M12	88 <sup>-0/+2</sup>	54	0,19
GE - 1"	94092501	94092502	94092503	1" x 17 mm	25	45	78	54	M12	108 <sup>-0/+2</sup>	66	0,28
GE - 1"	-	94092602	94092603	1" x 17 mm	-	45	78	54	M20	108 <sup>-0/+2</sup>	66	0,28
GE - 1"1/4	94093101	94093102	94093103	1"1/4 x 3/4"	25	54	90	54	M20	108 <sup>-0/+2</sup>	66	0,28
GE - 1"1/2	94093801	94093802	94093803*	1"1/2 x 1"	25	71	119	54	M20	108 <sup>-0/+2</sup>	66	0,28
<b>GO</b> GO - 3/8"	94110901	94110902	94110903	3/8 x 7/32"	20	20	25	34	M8	70	35	0,10
GO - 1/2"	94111201	94111202	94111203	1/2" x 5/16"	20	20	35	34	M10	70	35	0,11
GO - 5/8"	94111501	94111502	94111503	5/8" x 3/8"	20	25	40	44	M10	90	45	0,17
<b>GA</b> GO - 1"	94112501	94112502	94112503	1" xs 17 mm	25	45	78	54	M12	110	55	0,28
GO - 1"1/4	94113101	94113102	94113103	1"1/4 x 3/4"	25	54	90	54	M20	110	55	0,28
GO - 1"1/2	94113801	94113802	94113803*	1"1/2 x 1"	25	71	119	54	M20	110	55	0,28
<b>GA</b> GA - 3/8"	94080901	94080902	94080903	3/8 x 7/32"	20	20	25	39	M8	140	120	0,16
GA - 1/2"	94081201	94081202	94081203	1/2" x 5/16"	20	20	35	39	M10	140	120	0,16
GA - 5/8"	94081501	94081502	94081503	5/8" x 3/8"	20	25	40	39	M10	140	140	0,23
GA - 3/4"	94081901	94081902	94081903	3/4" x 7/16"	20	30	49	39	M12	140	140	0,23
GA - 1"	94082501	94082502	94082503	1" x 17 mm	25	45	78	39	M12	140	160	0,30



GE



GO



GA



**TRACEN**